



Model 15110 Tube Conveyor (Shown)

1565, 1575, 1585, 1590, 15105 and 15110 Tube Conveyor

Capacity	Up to 6,000 BPH (Capacity depends on material, moisture, density, and angle)
Tubing	10" Diameter Tubes
Belt	15" 2-Ply Chevron
Belt Speed	Standard 600 FPM
S-Drive Options	Electric or PTO
Hopper	Collapsible Canvas Hopper
Unit Width	11' Outside Wheel Width
Construction	Carbon or Stainless Steel Available
Standard Accessories	Wind Guards, Extendable Axle
Optional Accessories	Bottom Guards



Proudly designed and manufactured in the USA.

800.311.9626 | WWW.TUBECONVEYOR.COM

1500 SERIES S-DRIVE, SCISSOR LIFT TUBE CONVEYOR

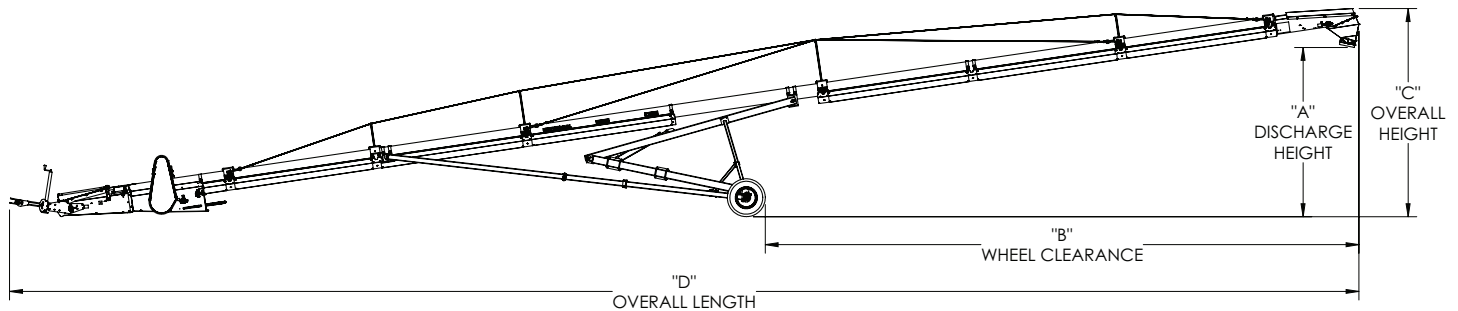

UniTube® Conveyor Measurements						Operating Power Requirements	
	Discharge	Wheel	Overall Height*	Transport	Overall Length	Electric	PTO
1565	26' 11¼"	31' 4"	29' 5¾"	12'	69' 10"	15	30
1575	31' 2¼"	31' 2"	33' 9"	12' 7¾"	79' 9¾"	15	40
1585	35' 4½"	36'	37' 11¼"	13' 1"	89' 11½"	20	40
1590	37' 6"	40' 6¼"	40' ½"	13' 10¼"	94' 10½"	25	50
15105	43' 9¼"	45' 1"	45' 11½"	13' 11½"	110' 6¼"	25	50
15110	45' 10½"	49' 7½"	48' ¾"	14' 6¼"	115' 5¾"	25	50

* At 25°

† Transport Height based on 18" Hitch Height

Specifications are subject to change without notice.

Uni Tube® is a brand of Universal Industries®



Unit application, location and specifications determine the type, quantity and/or placement of electrical, electrical safety or other safety controls required. Whether these controls are supplied by Universal Industries or another supplier, all OSHA safety and health standards, the National Electrical Code and local codes must be met and followed. Because we constantly strive to provide the finest material handling equipment, establishing industry standards, specifications must remain subject to change without notice.